

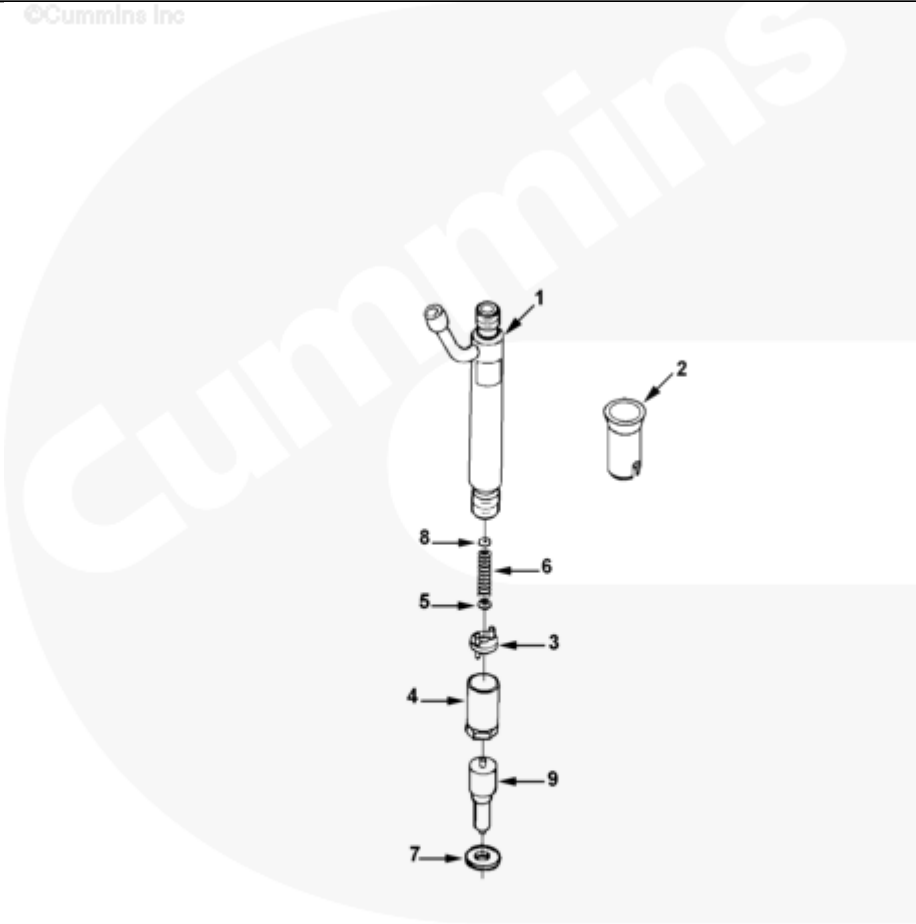

Parts Catalog - Option Detail

Electronic Parts Catalog - Option Detail				
Option	Group	Graphic	Film Card	Date
PP2664	06.01.1	fi940ga	Z	10-SEP-96
Engines	6C8.3, C GAS PLUS CM556, G8.3, G8.3 CM558, GTA8.3 CM558, ISC CM2150, ISC CM554, ISC CM850, ISC8.3 CM2250, ISC8.3 G CM2180 C101, ISL CM2150, ISL CM554, ISL CM850, ISL G CM2180, ISL8.9 CM2150 L110, ISL8.9 CM2880 L112, ISL9 CM2150 SN, ISL9 CM2250, ISL9 CM2350 L101, ISL9 CM2350 L111, ISLE4 CM850, L GAS PLUS CM556, L8.9, L8.9 L121, L8.9G CMOH2.0 L125B, L9 CM2350 L116B, L9 CM2350 L119B, L9 CM2350 L120C, L9 CM2350 L123B, L9.3 L105, L9.5 L117, L9N CM2380 L124B, QSC8.3 CM2250, QSC8.3 CM2880 C102, QSC8.3 CM554, QSC8.3 CM850(CM2850), QSL9 CM2250, QSL9 CM2250 L115, QSL9 CM2350 L102, QSL9 CM2350 L107, QSL9 CM2350 L118, QSL9 CM2350 L122, QSL9 CM554, QSL9 CM850(CM2850), QSL9 G CM558, QSL9 M CM2250 L106, QSL9.3 CM2880 L113			



fi940ga

SMALL | MEDIUM | LARGE

Cart	Ref No	Part Number	Part Description	Required	Remarks
View My Cart					
		PP2664	Fuel Injector		MR - PARTS, PERFORMANCE...(More)
					Performance Parts for:
					6CTAA8.3 Litre
					Engine Family: C Series
					Reference CPL#: 2664
					Base Turbo ID17: 3535749
					Certified By: None
					Cylinders: 6
					Exh Mfld Type: Dry
					Aspiration: Charged Air
					Cooled
					Engine Control System: MRE
					Fuel Pump Manufacturing /
					Model: Bosch P3000
					Catalytic Converter Required:
					No
					High Pressure Fuel Line ID
					(mm): 1.8
					Unique Characteristics: With
					Edge Filter Injectors
					Cylinder Head Valve Material:
					Premium
					Cyl Head Valve Inserts: No
					Valve Bridge Scalloping: No
					Required Cylinder Head Swirl:
					Low
					Camshaft Gear Material:
					Steel

					Required Lube Pump Flow (GPM
					at RPM): 27.5 at 2200
					Requires Graded Pistons: No
					Engine Design Phase: Current
					Product
					For Use With Electronic
					Governor Only
					Brazil May Use P/N 3934169
					Instead of 3935715
<input type="checkbox"/>		3802754	Injector	6	
	1	3930523	Injector	1	Sold In Higher Level Assy/Kit
<input type="checkbox"/>	2	3909886	Injector Seal	1	
<input type="checkbox"/>	3	3905154	Intermediate Disc	1	
<input type="checkbox"/>	4	3905155	Injector Nozzle Retainer	1	
<input type="checkbox"/>	5	3915118	Injector Spindle	1	
<input type="checkbox"/>	6	3915119	Compression Spring	1	
<input type="checkbox"/>	7	3923261	Injector Seal	1	
8					See Group 06.01.2
<input type="checkbox"/>	9	3930524	Injector Nozzle	6	